

ENGINEERED STEP TUBES

Installation Instructions

CONTENTS:

(2) STEP TUBES	(8) H-070 M8 X 30mm HEX BOLT	(8) H-012 5/16 LOCK WASHER
(1) H-476 (L) FRONT BRKT.	(8) H-038 3/8 LOCK WASHER	(8) H-030 5/16 HEX NUT
(1) H-479 (R) FRONT BRKT.	(8) H-037 3/8 FLAT WASHER	
(1) H-477 (L) REAR BRKT.	(8) H-063 5/16 X 1 1/4 HEX BOLT	
(1) H-478 (R) REAR BRKT.	(16) H-011 5/16 FLAT WASHER	

1.) Locate the two factory tapped holes under the front drivers side. Remove rubber grommet if required. Install the H-476 (L) front bracket with two M8 X 30 hex bolts, flat and lock washers. Leave loose.

2.) Locate the two factory tapped holes under the rear drivers side. Remove rubber grommets if required. Install the H-477 (L) rear bracket with two M8 x 30 hex bolts, flat and lock washers. Leave loose.

3.) Attach the tube to the bracket with four 5/16 x 1 1/4 hex bolts, eight flat washers, four lock washers and four hex nuts. Align tube with rocker panel and tighten all hardware. torque M8 and 5/16 fasteners to 12 ft/lbs each.

4.) repeat steps on oppsite side.

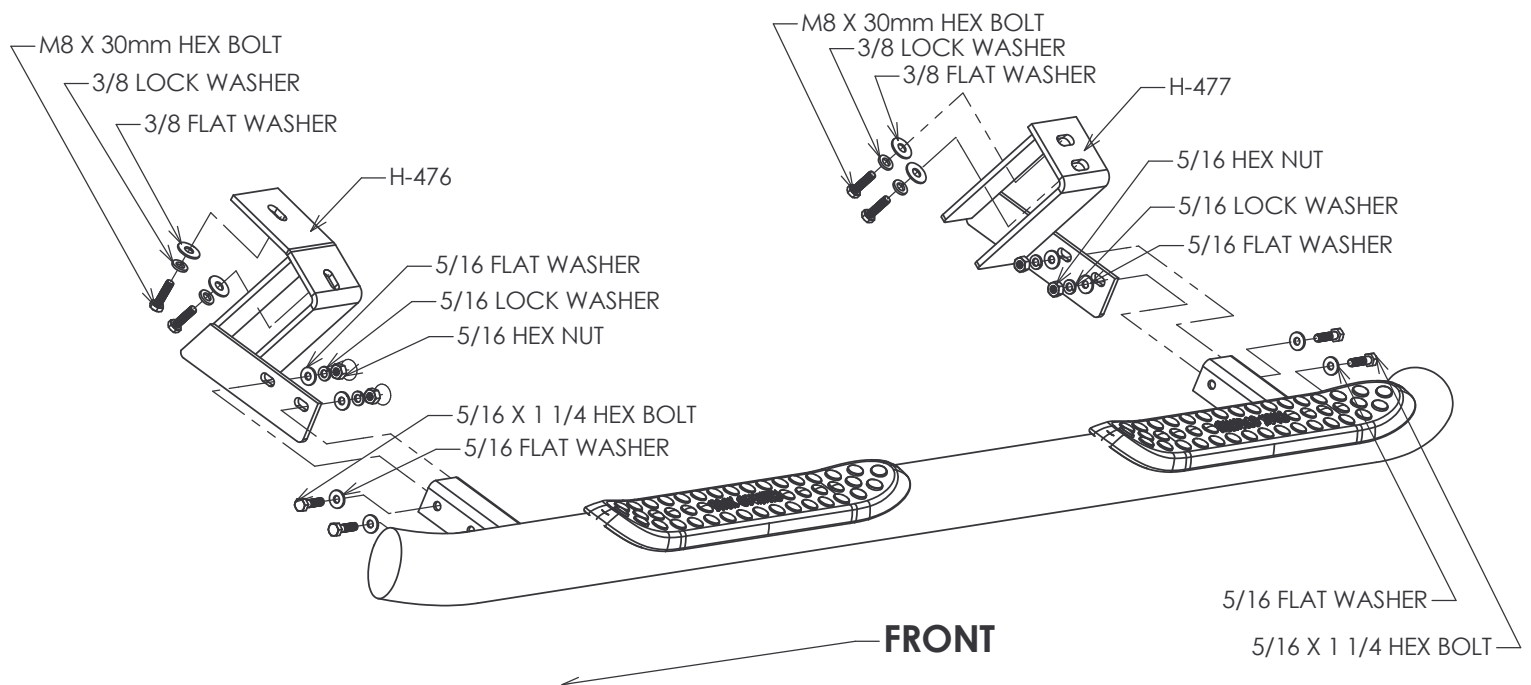

ORIGINAL 4/02/03